

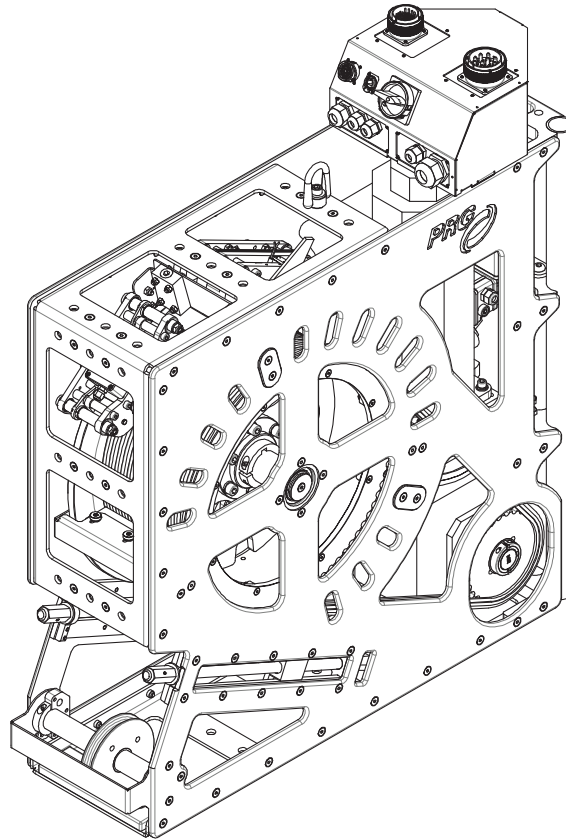

ST12 PERFORMER FLY HOIST

SPECIFICATION SHEET



AAB-6294

500 LBS [226 KG] WLL (7.5 KW)

6.3 FT/S [1.9 M/S] MAX SPEED

Ø1/4" LIFTING CABLE

100 FT [30.4 M] TRAVEL

ANSI E1.43-2016

ANSI E1.6-1-2021

Description

The SF12 Performer Fly Hoist is a versatile single-axis cable hoist, capable of performer flight operations with a working load limit of 500 lb.

An AC servo motor ensures safe operation, and the hoist can be controlled via any PRG Stage Command® 7.5 kW drive system. With two independent brake systems, cross-groove sensors, easy-to-adjust limit switches, a SIL3 absolute encoder, and optional slack line sensors, your scenery moves safely every time.

Flexible mounting options are available, and the hoisting line can be rigged for vertical or horizontal applications. An integrated accessory mounting system allows for custom solutions and accessories to fit your requirements.

Trust the SF12 Hoist for your performer flight needs, and experience a reliable and safe performance every time.



ST12 PERFORMER FLY HOIST

SPECIFICATION SHEET

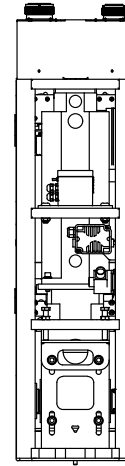
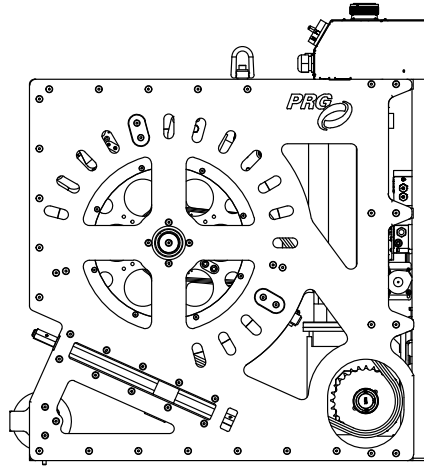
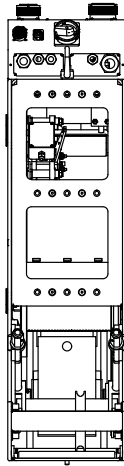
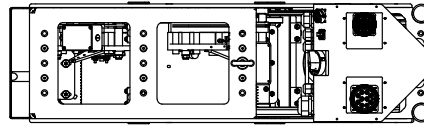

Specifications	U.S. Customary	S.I.
Dimensions (WxHxL)	12 x 46.15 x 42.5 in	304.8 x 1 173 x 1 080 mm
Weight	600 lb	272 kg
Lifting Media	1x 1/4" 7x19 Galvanized Steel Wire Rope (Contact PRG for special options such as rotation resistant rope.)	
Working Load Limit	500 lb	226 kg
Characteristic Load	600 lb	272 kg
Peak Load	1 250 lb	567 kg
Max Velocity	6.3 ft/s	1.9 m/s
Cat-0 Stop	2.12 G	
Max travel Distance	100 ft	30.4 m
Motor Rated Output	6.3 HP	5.5 kW
Motor Rated Voltage	200V	
Motor Current	Continuous: 34 A	Peak: 39 A
Control System	PRG Stage Command® System	
Brake Capacity (Combined)	1 779 lb	806 kg
Optional Slack Line Sensor Part Number:	AAE-6972	

Designed in New Windsor, NY, USA