



# Bad Boy CMY® Automated Luminaire

The Bad Boy CMY® from PRG is an elegantly engineered, hybrid luminaire that combines the qualities of a traditional automated light with a large venue fixture.

Bad Boy is the ideal choice whenever a big-beam look is required, for example, when playing in front of high-brightness LED screens. Producing a powerful 48,000 lumens, the Bad Boy couples its high-definition optics with a Philips MSR Gold™ FastFit lamp that can be set to levels 900W, 1200W, or 1400W. Boasting an optical efficiency of over 40%, Bad Boy doubles standard efficiencies, marrying both brightness and green product ideals without compromise.

The Bad Boy CMY features a color-mixing system that allows for seamless crossfading between colors for unlimited creative possibilities.



## Dimensions

### POSITIONING:

Can be mounted in any orientation.

### SPACING:

Hangs on 30-inch (762 mm) centers.

### WEIGHT:

167 lbs (75.8 kg) - includes clamps and rails

Please see diagram on back

## Built-In LCD Touch Screen

Bad Boy features a built-in LCD touchscreen display, which provides access to control, configuration, status, and testing functions.



Sample Menu Screen

## Features

|                            |  |
|----------------------------|--|
| <b>SOURCE:</b>             | Philips MSR Gold™ 1200W FastFit Lamp. Can be set to levels 900W, 1,200W, or 1,400W.  |
| <b>OUTPUT:</b>             | 48,000 lumens  |
| <b>OPTICAL EFFICIENCY:</b> | 40%  |
| <b>REFLECTOR:</b>          | Precision glass reflector with dichroic cold mirror coating  |
| <b>OPERATING TEMP:</b>     | -20° to 120°F (-29° to 49°C)   |
| <b>COOLING:</b>            | Forced air   |
| <b>CONTROL:</b>            | Compatible with all PRG consoles and a wide variety of DMX512 and Art-Net consoles. An internal Ethernet switch allows for daisy-chaining fixtures   |
| <b>ON-BOARD CONTROL:</b>   | Built-in LCD display with touchscreen featuring menu system control  |
| <b>ZOOM RANGE:</b>         | 8:1 from narrow spot of 7° to wide flood of 56°  |
| <b>ZOOM CONTROL:</b>       | Four (4) groups of lenses — each independently controlled for accuracy while maintaining focus during zoom changes   |
| <b>BEAM SIZE CONTROL:</b>  | In addition to the zoom optics, a mechanical iris provides continuous beam size control for both rapid changes and smooth timed beam angle changes   |
| <b>EDGE CONTROL:</b>       | Maintains gobo focus and allows gobo morphing  |
| <b>STROBE:</b>             | Servo-powered, lightning fast strobe   |
| <b>FROST:</b>              | Variable frost for smooth diffusion  |
| <b>COLOR:</b>              | COLOR: CMY color system featuring three (3) crossfading color wheels of Cyan, Magenta, and Yellow, plus one (1) designer wheel with user-changeable color filters (The Bad Boy is also available with the Quantum Color® system) |
| <b>ROTATING GOBOS:</b>     | Two (2) indexable, rotating gobo wheels with seven (7) gobos per wheel. Gobos are individually calibrated so the unit will automatically index the orientation of each gobo regardless of placement                              |
| <b>PAN &amp; TILT:</b>     | Three-phase, high-speed servo motors   |
| <b>RANGE:</b>              | Pan - 540°, Tilt - 270°  |
| <b>MAX VELOCITY:</b>       | 4.1 seconds for 540° of pan and 3.2 seconds for 270° of tilt   |
| <b>ACCURACY:</b>           | 0.2° resolution  |
| <b>INTENSITY:</b>          | Full-field dimming from 0 to 100% with accurate slow-speed control and fast bumps  |
| <b>DMX:</b>                | 42 channels  |

## Bad Boy CMY® Luminaire Specifications

The unit is an integrally designed, remote controlled, motorized luminaire. The housing and yoke are constructed of aluminum and steel for lightweight strength and are forced-air cooled. The unit utilizes a Philips MSR Gold™ 1,200W FastFit lamp that can be set to levels 900W, 1,200W, or 1,400W. The lamp is easily changeable from the rear of the unit, eliminating the need to open the head for lamp access.

Two enclosed, high torque servo motors permit movement of the head on a horizontal plane of 540° and on a vertical plane of 270°. Control cabling runs internally to prevent tangling. The pan and tilt are belt-driven, providing positional resolution and repeatability of 0.2° on either axis. Manual override under power will not harm the drive mechanism. Pan and tilt locking mechanisms automatically unlock when power is applied to the fixture.

Each unit is equipped with an on-board microprocessor providing diagnostic and self-calibration functions. In the event the luminaire encounters any physical obstruction during calibration, the pan and tilt motors will automatically be disabled preventing damage to the mechanisms.

The Bad Boy CMY luminaire contains three (3) crossfading color wheels of Cyan, Magenta, and Yellow, plus one (1) designer wheel with user-changeable color filters. (The Bad Boy is also available with the Quantum Color® system.)

The unit contains two (2) indexable, rotating gobo wheels with seven (7) gobos per wheel. Gobos are individually calibrated so the unit will automatically index the orientation of each gobo regardless of placement. All gobos are easily removable from the unit. Positional accuracy of the gobo frame in reference to the beam is ensured by the microprocessor, which maintains count of both servo motors and magnetic sensors that define the open white positions.

The unit contains a mechanical iris which provides continuous beam size control for both rapid changes and smooth timed beam angle changes. Variable beam focus is provided to soften edges of gobos or spots and provide gobo morphing. The zoom optics system provides an 8:1 zoom range from narrow spot of 7° to wide flood of 56°. The unit is capable of full-field dimming from 0 to 100% with accurate slow-speed control and fast bumps. The unit also contains a servo-powered strobe mechanism for lightning fast strobe effects.

The unit is compatible with all PRG consoles and a wide variety of DMX512 and Art-Net consoles. An internal Ethernet switch allows for daisy-chaining fixtures. A built-in LCD display with touchscreen allows for on-board fixture control. On-board battery power allows a fixture address to be set without having to apply AC power to the luminaire.

A safety cable is provided with each unit. Exterior finish is black powder coat. Total weight does not exceed 167 lbs (75.8 kg). The unit is CE-marked.

## Dimensions

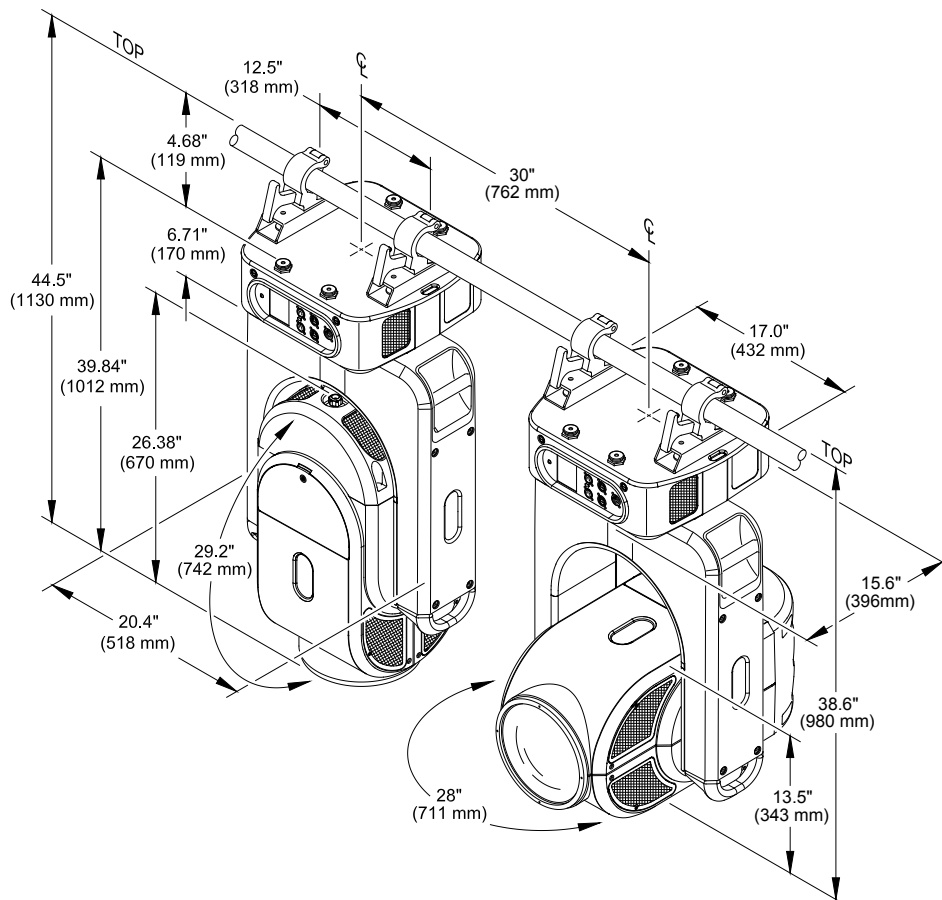

TOKYO  
SHANGHAI  
MELBOURNE  
SYDNEY  
LONDON  
BIRMINGHAM  
MAIDSTONE  
HAMBURG  
COLOGNE  
FRANKFURT  
MUNICH  
BERLIN  
DÜSSELDORF  
BRUSSELS  
PARIS  
UTRECHT  
MADRID  
ZURICH  
CAPE TOWN  
BUENOS AIRES  
NEW YORK  
NEW JERSEY  
WASHINGTON DC  
TORONTO  
DETROIT  
CHICAGO  
DEKALB  
ATLANTA  
ORLANDO  
NEW ORLEANS  
DALLAS  
DENVER  
LAS VEGAS  
LOS ANGELES

[WWW.PRG.COM](http://WWW.PRG.COM)

BAD BOY® AND QUANTUM COLOR® ARE REGISTERED TRADEMARKS OF PRODUCTION RESOURCE GROUP, LLC. MSR GOLD™ IS A TRADEMARK OF PHILIPS GROUP.

©2013 PRODUCTION RESOURCE GROUP, LLC. ALL RIGHTS RESERVED. SPECIFICATIONS ARE SUBJECT TO CHANGE WITHOUT NOTICE.

VERSION: SEPTEMBER 2013

**POSITIONING:**  
Can be mounted in any orientation.

**SPACING:**  
Hangs on 30 inch (762 mm) centers.

**WEIGHT:**  
167 lbs (75.8 kg) includes clamps & rails